

# MERIDIAN-N

One design, thousands of combinations

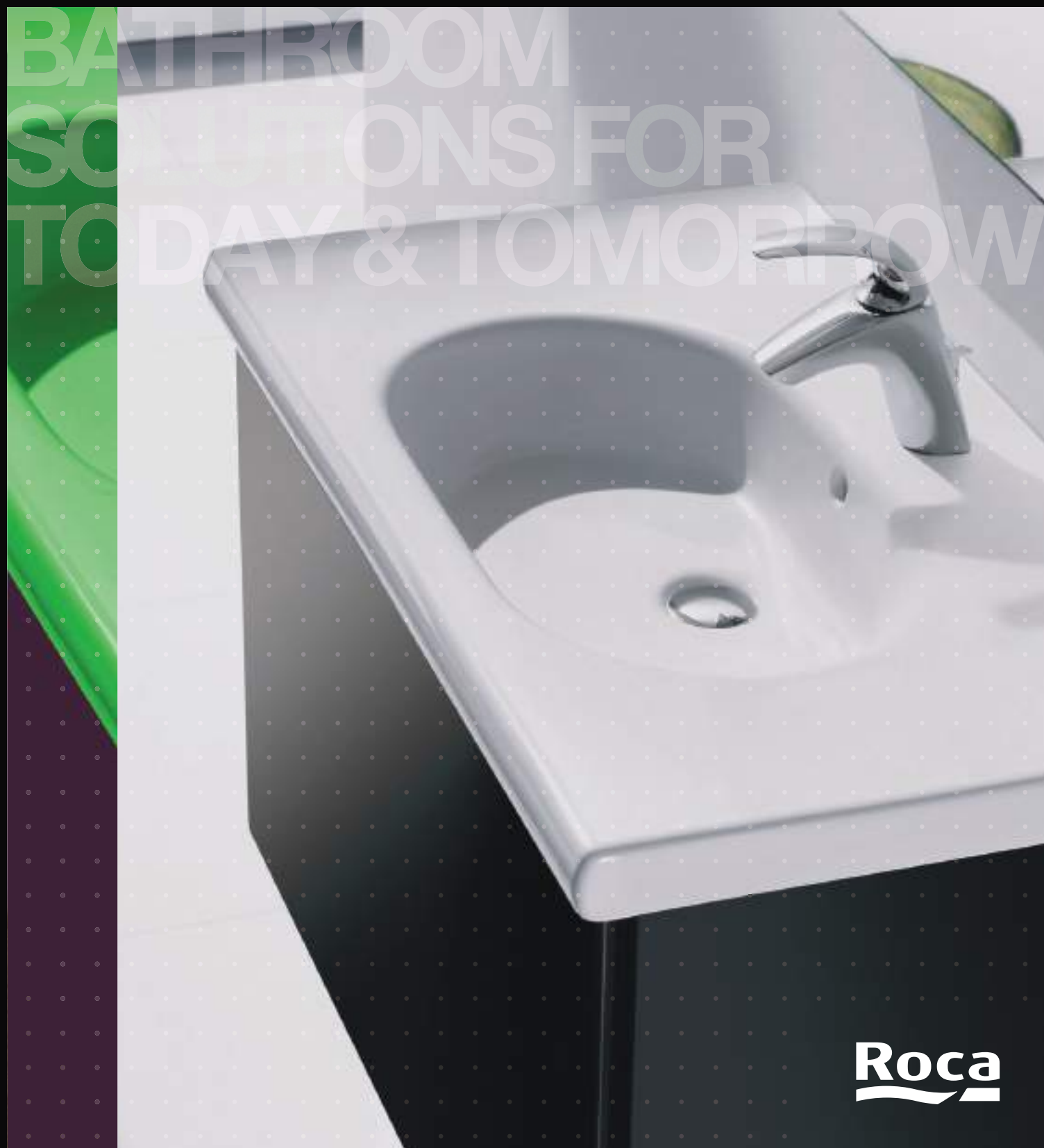

**Roca**



# Meridian-

One design, thousands  
of combinations

The stunning Meridian-N collection is showcased here with the M2-N and Esmal brassware collections, complementing each other to perfection and adding a new dimension to the bathroom space.

N



The Meridian-N collection offers the widest range of basins, toilets, bidets, seats and covers (soft-close or standard) as well as additional range options to perfectly tailor the bathroom to each taste and requirement.



Meridian-N 550 x 460 mm basin with full pedestal, standard (close-coupled) WC and bidet, M2-N brassware, Luna mirror.







Meridian-N Compact 550 x 320 mm (RH) basin with semi-pedestal, Compact (close-coupled) WC and bidet, Esmal brassware, Luna mirror.





Meridian-N asymmetrical 750 x 460 mm (LH) basin with semi-pedestal. Standard back-to-wall WC and Compact bidet. M2-N brassware, Luna mirror.



Meridian-N asymmetrical 750 x 460 mm (RH) basin with Totem bottle trap. Compact wall-hung WC and bidet, M2-N brassware, Luna mirror.





Large, compact, double or asymmetrical basins, with or without pedestal/semi-pedestal... The possibilities are endless; making the process of choosing products to define the look of the space an enjoyable exercise. Just choose the options which best reflect your personal style.



Compact solutions make space saving within the bathroom easier than ever before.

The Meridian-N collection offers a multitude of combinations to meet all needs in different bathroom spaces.

The compatibility of the collection with the Esmal and M2-N brassware when combined with a variety of towel rails and vitreous china accessories, results in a vast number of options for a single bathroom space.



Meridian-N Compact 550 x 320 mm (RH) basin with semi-pedestal and optional towel rail. Esmal brassware.



To complement the Meridian-N collection we also present the Unik concept. An integrated basin and furniture solution offering maximum storage capacity.



Meridian-N Unik solution, M2-N brassware.





The furniture range consists of base units and countertops to complement the range basins. Square, modern and functional, the range is available in Gloss White or Oak and the countertops, suitable for the standard size units are also available in a Black solid surface.



Meridian-N Compact WC, basin and furniture, Esmal brassware.

# Meridian-N

One design, thousands of combinations.

- Double basin with ledge**  
1250 x 460 mm with fixing kit.  
Ref. 32724A000 1 taphole per bowl.\* £314.19
- Pedestal.**  
Ref. 337240000 £89.17
- Semi-pedestal, with fixing kit.**  
Ref. 337241000 £86.55
- Optional:**  
Towel rail 320 mm.  
Ref. 816291001 £65.08
- Modular shelf extension, 260 x 320 mm.**  
Ref. 387240000 £103.11

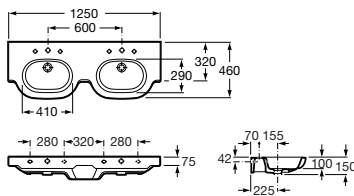

- Basin with ledge, with fixing kit.**  
Ref. 32724B000 1000 x 460 mm 1 taphole.\* £280.53  
Ref. 32724D000 850 x 460 mm 1 taphole.\* £258.09  
Ref. 327240000 700 x 460 mm 1 taphole.\* £235.64
- Pedestal.**  
Ref. 337240000 £89.17
- Semi-pedestal, with fixing kit.**  
Ref. 337241000 £86.55
- Optional:**  
Towel rail 320 mm.  
Ref. 816291001 £65.08
- Modular shelf extension, 260 x 320 mm.**  
Ref. 387240000 £103.11

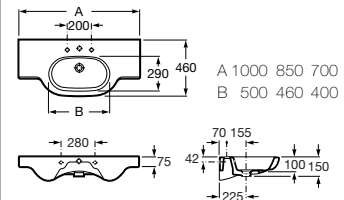

- Modular shelf extension, 260 x 320 mm with fixing kit.**  
Ref. 387240000 £103.11

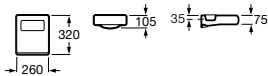

- Compact basin, with fixing kit.**  
Ref. 32724T000 £196.37  
600 x 320 mm. Right hand, 1 taphole.  
Ref. 32724X000 £196.37  
600 x 320 mm. Left hand, 1 taphole.  
Ref. 32724Y000 £162.71  
550 x 320 mm. Right hand, 1 taphole.  
Ref. 32724Z000 £162.71  
550 x 320 mm. Left hand, 1 taphole.
- Semi-pedestal, with fixing kit.**  
Ref. 337242000 £86.55
- Optional:**  
Towel rail 320 mm.  
Ref. 816291001 £65.08
- Modular shelf extension, 260 x 320 mm.**  
Ref. 387240000 £103.11

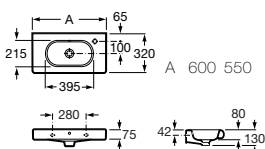

- Compact cloakroom basin, 350 x 320 mm with fixing kit.**  
Ref. 327249000 1 taphole. £98.75
- Semi-pedestal, with fixing kit.**  
Ref. 337242000 £86.55
- Optional:**  
Towel rail 320 mm.  
Ref. 816291001 £65.08
- Modular shelf extension, 260 x 320 mm.**  
Ref. 387240000 £103.11

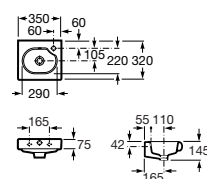

- Compact cloakroom basin, 450 x 250 mm with fixing kit.**  
Ref. 327248000 1 taphole. £106.61

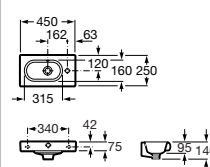

Asymmetrical basin, 750 x 460 mm with fixing kit. £252.48  
 Ref. 32724L000 Left hand 1 taphole.\* £252.48  
 Ref. 32724R000 Right hand 1 taphole.\* £235.64

Pedestal.  
 Ref. 337240000 £89.17

Semi-pedestal, with fixing kit.  
 Ref. 337241000 £86.55

Optional:  
 Towel rail 320 mm.  
 Ref. 816291001 £65.08

Modular shelf extension, 260 x 320 mm.  
 Ref. 387240000 £103.11

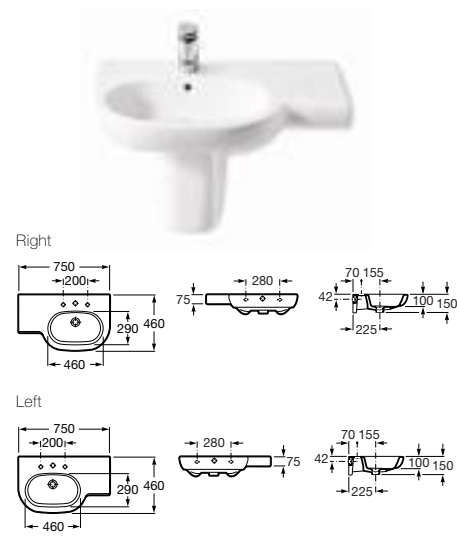

Basin, with fixing kit.  
 Ref. 327241000 650 x 460 mm 1 taphole.\* £222.83  
 Ref. 327242000 600 x 460 mm 1 taphole.\* £185.15  
 Ref. 327243000 550 x 460 mm 1 taphole.\* £156.07  
 Ref. 327244000 500 x 460 mm 1 taphole.\* £132.41

Pedestal.  
 Ref. 337240000 £89.17

Semi-pedestal, with fixing kit.  
 Ref. 337241000 £86.55



Cloakroom basin, 450 x 420 mm with fixing kit.  
 Ref. 327245000 1 taphole.\* £99.68

Pedestal.  
 Ref. 337240000 £89.17

Semi-pedestal, with fixing kit.  
 Ref. 337241000 £86.55



Corner handbasin, 350 x 350 mm with fixing kit.  
 Ref. 32724C000 1 taphole. £92.01



In-countertop basin, 600 x 340 mm with fixing kit.  
 Ref. 32724E000 1 taphole. £174.43



Semi-recessed basin, 550 x 420 mm. with fixing kit.  
 Ref. 32724S000 1 taphole.\* £212.45



\*These basins have countersunk holes which can be drilled to suit the number of holes required. 1 tap hole basins can be drilled for 3 tap holes where required for a fee.

Standard WC suite consisting of:

Standard close-coupled WC, 645 mm projection, dual outlet, open back, with fixing kit. Ref. 342247000	£233.43
Cistern with dual flush 4.5/3 or 6/3 litres. Ref. 34124C000	£204.59
Soft-close WC seat and cover. Ref. 8012A20004	£100.98
Luxury WC seat and cover. Ref. 8012A0004	£74.76

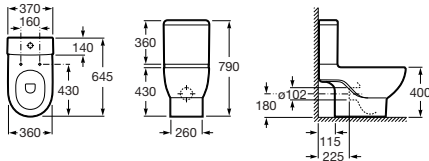

Compact WC suite consisting of:

Compact close-coupled WC, 600 mm projection, dual outlet, moulded back-to-wall, with fixing kit. Ref. 342248000	£258.09
Cistern with dual flush 4.5/3 or 6/3 litres. Ref. 34124D000	£222.17
Soft-close WC seat and cover. Ref. 8012AC004	£100.98
Luxury WC seat and cover. Ref. 8012AB004	£74.76

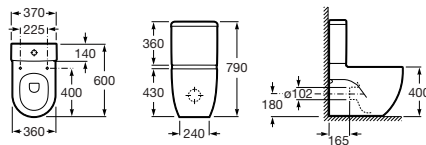

Back-to-wall WC suite consisting of:

Back-to-wall WC, 520 mm projection, dual outlet, with fixing kit. Ref. 347247000	£280.53
Soft-close WC seat and cover. Ref. 8012A2004	£100.98
Luxury WC seat and cover. Ref. 8012A0004	£74.76

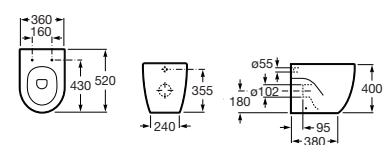

Standard bidet consisting of:

Standard bidet, 560 mm projection, with fixing kit. Ref. 357244000 1 taphole.	£175.72
Soft-close bidet cover. Ref. 8062A2004	£96.50
Bidet cover. Ref. 8062A0004	£74.76

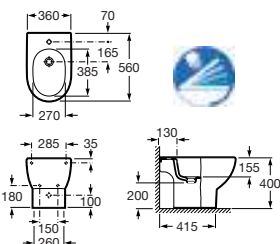

Compact bidet consisting of:

Compact bidet, 520 mm projection, moulded back-to-wall with fixing kit. Ref. 357247000 1 taphole.	£196.37
Soft-close bidet cover.* Ref. 8062AC004	£96.50
Bidet cover.* Ref. 8062AB004	£74.76

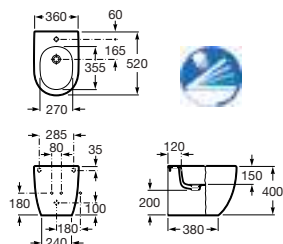

Standard wall-hung bidet consisting of:

Standard wall-hung bidet, 560 mm projection, with fixing kit. Ref. 357245000 1 taphole.	£321.30
Soft-close bidet cover.* Ref. 8062A2004	£96.50
Bidet cover.* Ref. 8062A0004	£74.76

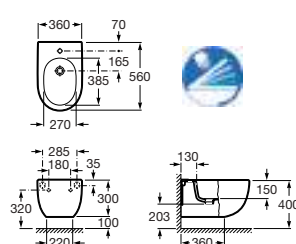

Compact wall-hung bidet consisting of:

Compact wall-hung bidet, 480 mm projection, with fixing kit. Ref. 357246000 1 taphole.	£342.24
---	---------

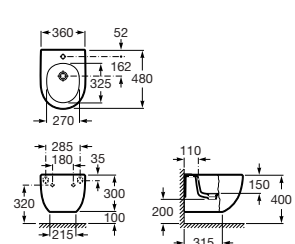

\*Bidet covers for back-to-wall and wall-hung bidets must be fitted before installation of the bidet.



Standard wall-hung WC suite consisting of:

Wall-hung WC, 560 mm projection,  
with fixing kit.

Ref. 346247000

£418.36

Soft-close WC seat and cover.

Ref. 8012A2004

£100.98

Luxury WC seat and cover.

Ref. 8012A0004

£74.76

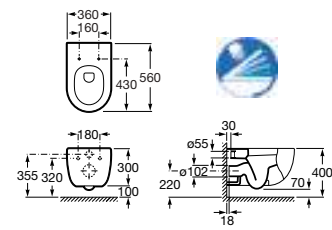

Compact wall-hung WC suite consisting of:

Compact wall-hung WC, 480 mm projection,  
with fixing kit.

Ref. 346248000

£398.35

Soft-close WC seat and cover.

Ref. 8012AC004

£100.98

Luxury WC seat and cover.

Ref. 8012AB004

£74.76

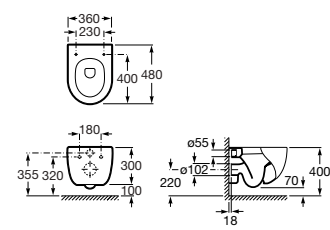

Meridian-N Unik.  
Base module, 850 x 463 mm.

Ref. 855709XXX

£927.77

Meridian-N Unik.  
Column module, 350 x 800 x 181 mm.

Ref. 856371XXX

£502.02

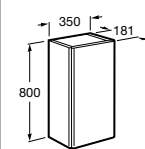
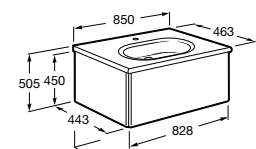

Range of colours for vitreous china



White only.

Range of finishes for Unik furniture (lacquered)



858 Matt White

868 Matt Black

829 Matt Stone

Replace the (XXX) of the product reference with the chosen finish code detailed above for Meridian-N Unik.

Range of finishes for furniture.



01 Gloss White      06 Oak

Replace the (XX) of the product reference with the chosen finish code.

Range of finishes for countertops.

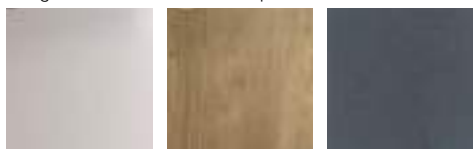

01 Gloss White      06 Oak      Black

Black countertops are made from a solid surface and are pre-cut to suit the basin.  
Replace the (..) of the product reference with the chosen finish code (Black countertops have their own product reference).

**Countertops**

For 625 wide unit.

Ref. 856206M.. For 650 or 600 basin.	£82.80
Ref. 856201M15 For 650 basin – Black.	£175.95
Ref. 856202M15 For 600 basin – Black.	£175.95

For 525 wide unit.

Ref. 856207M.. For 550 or 500 basin.	£72.45
Ref. 856203M15 For 550 basin – Black.	£165.60
Ref. 856204M15 For 500 basin – Black.	£165.60

For 425 wide unit.

Ref. 856208M.. For 450 basin.	£62.10
Ref. 856205M15 For 450 basin – Black.	£155.25

Furniture to suit 600, 550, 450 and 350 compact basins (countertops not required).

**Compact base units**

One drawer.

Ref. 856001MXX 580 (to suit 600 compact basin).	£289.80
Ref. 856003MXX 525 (to suit 550 compact basin).	£279.45

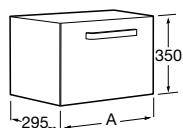

A 580 525

Two drawers.

Ref. 856002MXX 580 (to suit 600 compact basin).	£341.55
Ref. 856004MXX 525 (to suit 550 compact basin).	£279.45

Optional legs – pair (205h) 816412001.

£51.22

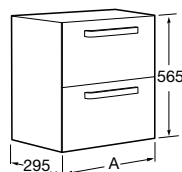

A 580 525

Furniture to suit 650, 600, 550, 500 and 450 basins (countertops must be ordered separately).

**Base units**

One drawer.

- Ref. 856009MXX 625 (to suit 650 and 600 basins). £310.50
- Ref. 856011MXX 525 (to suit 550 and 500 basins). £300.15
- Ref. 856013MXX 425 (to suit 450 basin). £289.80

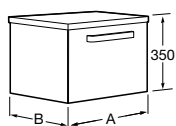

A 625 525 425  
B 440 440 400

Two drawers.

- Ref. 856010MXX 625 (to suit 650 and 600 basins). £372.60
- Ref. 856012MXX 525 (to suit 550 and 500 basins). £362.25
- Ref. 856014MXX 425 (to suit 450 basin). £351.90

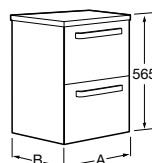

A 625 525 425  
B 440 440 400

- Optional legs – pair (205h) 816412001. £51.22
- Optional plinth – metallic (180h) 856401M03. £77.63

**Compact base units**

One door (half height).

- Ref. 856007MXX 425 (to suit 450 compact basin). £175.95
- Ref. 856005MXX 330 (to suit 350 compact basin). £186.30

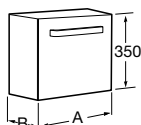

A 425 330  
B 225 295

One door.

- Ref. 856008MXX 425 (to suit 450 compact basin). £207.00
- Ref. 856006MXX 330 (to suit 350 compact basin). £217.35

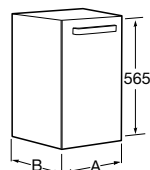

A 425 330  
B 225 295

- Optional legs – pair (205h) 816412001. £51.22

## Roca is the world leader in bathroom spaces.

For many years we have anticipated  
the future, thinking of solutions  
that better adapt to the public's tastes  
and requirements.

1. Ramón Benedito
2. Belén & Rafael Moneo
3. Antonio Bullo
4. Carles Ferrater
5. Ricard Ferrer
6. Giorgetto Giugiaro
7. Carlo Urbinati
8. Marcello Cutino
9. David Chipperfield
10. Schmidt & Lackner
11. Roviras & Torrente
12. Herzog & de Meuron
13. Magma Design
14. Gabriele & Oscar Buratti
15. Joan Gaspar



### Design

We surround ourselves with  
the world's finest architects and  
designers, such as Chipperfield,  
Moneo, Schmidt & Lackner, Herzog  
& de Meuron... We want to offer a  
design that will make your bathroom  
a unique space.

### Innovation

We have our own Innovation Lab  
where we experiment every day with  
new ideas, designs and materials,  
with the sole aim of enhancing your  
bathroom experience and providing  
solutions to make your everyday life  
more comfortable.

### Sustainability

We love our planet and we prove  
it every day. This is why our  
products have advanced water-  
and energy-saving devices that  
permit a balanced and sustainable  
coexistence with our environment.

Many of our products are registered  
with the Water Efficiency Product  
Labelling Scheme, meaning they  
have been independently verified as  
being water efficient. Look out for the  
WEPLS logo.

### The Roca Guarantee

Every one of the products we sell  
complies with all specific European  
regulations. We offer you the finest  
product with the best guarantee.  
Our goal is your total satisfaction.

The quality of Roca products has been acknowledged throughout the world.

- 2011** ■ **XAVER 2011.** "The Wave", the space presented by Roca at the last 100% Design London exhibition, has been honoured with the award granted by the Expo+Event Swiss Association.  
 ■ **Silver Delta Award** for the best product design for W+W.  
 ■ **Gold IF Communication Design Award 2011.**  
 Roca's space at the last 100% Design London show has been honoured by International Forum Design.  
 ■ **"The 100 Best Ideas" of the year 2010.**  
 Roca's W+W product has been honoured as one of the Best Ideas of the Year 2010, in the special ranking published by the prestigious magazine *Actualidad Económica*.  
 ■ **Architectural Record 2011 Award.**  
 The Roca Barcelona Gallery has won the Good Design is Good Business award in recognition of its excellence.  
 ■ **Shortlisted at the XI Spanish Architecture and Urban Planning Biennale.** Roca Barcelona Gallery.
- 2010** ■ **Cannes Lions 2010. Gold Lion.**  
 Projection "Rituals" for Roca Barcelona Gallery.  
 ■ **Cannes Lions 2010. Silver Lion.**  
 Experience "Momentums" for Roca Barcelona Gallery.  
 ■ **IALD Lighting Design Awards.**  
 The world's most prestigious lighting award, granted to Roca Barcelona Gallery's façade.  
 ■ **Wallpaper\* Design Award winner.** W+W is the "Gold Winner" in the "Product Innovation Awards 2009," and the Roca Barcelona Gallery wins the Wallpaper\* Design Award 2010.
- 2009** ■ **Red Dot award.** Awarded in the "Informative Design / Public Space" category for the best space at the 50th edition of the ISH 09 fair held in Frankfurt.  
 ■ **Design Plus Award.**  
 The W+W basin and toilet, designed by Gabriele & Oscar Buratti.
- 2008** ■ **The DME Design Management Europe Award.** A European distinction for the best design management in a large company.  
 ■ **FAD Award for Ephemeral Spaces.**  
 For the "Species Evolution" space presented at Casa Decor Barcelona 2007 by Martín Azúa and Nacho Martí.  
 ■ **VII Tile of Spain Architecture and Interior Design Awards.**
- 2003** ■ **Top Ten Marketing Leader Award.**
- 2002** ■ **Spain's National Design Award.**  
 The National Design Prizes, of an honorary nature, are the highest distinction awarded in Spain to companies who successfully use design in their innovation strategy.
- 2001** ■ **ADI-FAD Silver Delta Award:** Kalahari basin, designed by Benedito Design.
- 1999** ■ **The Barcelona Chamber of Commerce Epsilon Award,** granted by the ADI-FAD Executive Board for Design Quality in Business.
- 1997** ■ **Design Center Stuttgart International Design Award:** Sidney vitreous china series and Amura faucet series, designed by Schmidt & Lackner.
- 1993** ■ **Design Center Stuttgart International Design Award:** Meridian vitreous china series, designed by Schmidt/Lackner.  
 ■ **CEVISAMA Award,** International Industrial Design and Technological Innovation Competition: Clio basin, designed by Bernal/Isern.  
 ■ **Prince Felipe Award** for Business Excellence, Industrial Design Section.
- 1992** ■ **Spain's National Quality Award.**  
 The aim of the National Quality Prize is to disseminate the importance of quality as an indispensable factor in industrial activity.
- 1974** ■ **Spanish Housing Ministry's Extraordinary Award** for Industrial Design. The Valencia Ceramics and Glass Show.

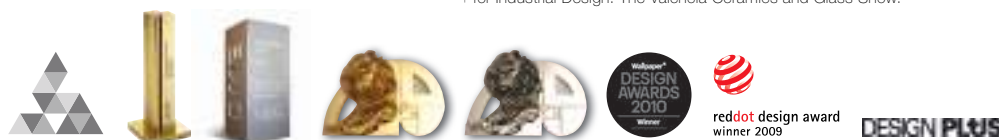

## Roca Solutions.

Roca offers you a multitude of solutions for the various elements that make up your bathroom. For further information, please consult your Roca Dealer or visit [www.roca.com](http://www.roca.com)



### United Kingdom

#### Roca Limited

Samson Road  
Hermitage Industrial Estate  
Coalville, Leicestershire.  
LE67 3FP – UK  
Telephone +44 1530 830080  
Fax +44 1530 830010  
[www.roca.com](http://www.roca.com)

#### Roca London Gallery

Station Court  
Imperial Wharf  
London  
SW6 2PY – UK  
Telephone +44 20 7610 9503  
Fax +44 20 7348 7236  
[www.rocalondongallery.com](http://www.rocalondongallery.com)

### Head Office

#### Roca Sanitario, S.A.

Avda. Diagonal, 513  
08029 Barcelona – Spain  
Telephone +34 93 366 1200  
Fax +34 93 419 4501  
[www.es.roca.com](http://www.es.roca.com)

#### Roca Barcelona Gallery

Joan Güell, 211-213  
08028 Barcelona – Spain  
Telephone +34 93 366 12 12  
Fax + 34 93 339 68 74  
[www.rocabarcelonagallery.com](http://www.rocabarcelonagallery.com)

#### Roca Madrid Gallery

José Abascal, 57  
28003 Madrid – Spain  
Telephone +34 91 442 3034  
Fax + 34 91 399 2227  
[www.rocamadridgallery.com](http://www.rocamadridgallery.com)

#### Expo Bath Barcelona

Avda. Sarriá, 131-135  
08017 Barcelona – Spain  
Telephone +34 93 280 2929  
Fax +34 93 280 0236

### Roca in Europe

#### Germany

Roca GmbH  
Feincheswiese 17  
D-56424 Staudt – Germany  
Telephone +49 2602 93 610  
Fax +49 2602 93 6122  
[www.roca.com/de](http://www.roca.com/de)

#### Austria

Laufen Austria, AG.  
Mariazeller Strasse, 100  
A-3150 Wilhelmsburg – Austria  
Telephone +43 2746 60 60 0  
Fax +43 2746 60 60 390  
[www.roca.com](http://www.roca.com)

#### Benelux

Laufen Benelux, B.V.  
Postbus 2702  
NL-3821 BM Amersfoort –  
The Netherlands  
Telephone +31 0 33 450 20 90  
Fax +31 0 33 450 20 91  
[www.rocabathrooms.nl](http://www.rocabathrooms.nl)

#### Bulgaria

Roca Bulgaria A.D  
5, Pirotska Str.  
1301 Sofia – Bulgaria  
Telephone +359 2 9305910  
Fax +359 2 9305919  
[www.roca-bulgaria.bg](http://www.roca-bulgaria.bg)

#### Showroom Sofia

16, Maria Luiza Blvd  
1000 Sofia – Bulgaria  
Telephone +359 2 939 60 90  
Fax +359 2 939 60 80

#### Croatia

Inker  
Industrijska, 1  
10290 Zapresic – Croatia  
Telephone +385 133 103 64  
Fax +385 133 102 75  
[www.roca.com](http://www.roca.com)

#### Slovakia

Laufen SK s.r.o.  
Stefanovicova 12  
811 04 Bratislava – Slovakia  
Telephone +421 252 621 024  
Fax +421 252 621 025  
[www.roca.cz](http://www.roca.cz)

#### Spain

Roca Sanitario, S.A.  
Avda. Diagonal, 513  
08029 Barcelona – Spain  
Telephone +34 93 366 1200  
Fax +34 93 419 4501  
[www.roca.com](http://www.roca.com)

#### Showroom Madrid

José Abascal, 57  
28003 Madrid – Spain  
Telephone +34 91 441 3500  
Fax + 34 91 442 4802

#### Showroom Barcelona

José Abascal, 57  
28003 Madrid – Spain  
Telephone +34 93 280 2929  
Fax +34 93 280 0236

#### France

Roca  
B.P. 90422  
95005 Cergy – Pontoise Cedex –  
France  
Telephone +33 134 40 3900  
Fax +33 130 37 0265 / 134 64 1355  
[www.roca.fr](http://www.roca.fr)

#### Greece

Roca Hellas, S.A.  
59, Agiou Konstantinou&Elenis street  
Ag. Dimitrios  
17342 Athens – Greece  
Telephone +30 210 8054721  
Fax +30 210 8054721  
[www.roca.com](http://www.roca.com)

#### Hungary

Laufen CZ s.r.o.  
Ordógarok u. 121  
H-1029 Budapest – Hungary  
Telephone +36 1 376 96 24  
Fax +36 1 376 96 24  
[www.roca.com](http://www.roca.com)

#### Italy

Roca S.r.l.  
Via Leonardo da Vinci, 24  
20080 Casarile (MI) – Italy  
Telephone +39 02 90 02 51  
Fax +39 02 90 52174  
[www.roca-italia.it](http://www.roca-italia.it)

#### Baltic states

Laufen CZ s.r.o. – Baltic Office  
Užupio g. 30  
LT-01203 Vilnius – Lithuania  
Telephone +370 5 215 3076  
Fax +370 5 215 3086  
[www.roca.lt](http://www.roca.lt)

#### Nordic countries

Laufen Nordic Aps  
Fejovej 8  
DK-4652 Hårlev – Denmark  
Telephone +45 56 287 287  
Fax +45 56 287 237  
[www.roca.com](http://www.roca.com)

#### Poland

Roca Polska Sp. z o.o.  
ul. Wyczółkowskiego, 20  
44-109 Gliwice – Poland  
Telephone +48 32 339 4100  
Fax +48 32 339 4102  
[www.roca.pl](http://www.roca.pl)

#### Portugal

Roca S.A.  
Apartado 575  
Ponte da Madalena  
2416 – 905 Leiria – Portugal  
Telephone +351 244 720 000  
Fax +351 244 722 373  
[www.roca.pt](http://www.roca.pt)

#### United Kingdom

Roca Limited  
Samson Road  
Hermitage Industrial Estate  
Coalville, Leicestershire. LE67 3FP – UK  
Telephone +44 1530 830080  
Fax +44 1530 830010  
[www.roca-uk.com](http://www.roca-uk.com)

#### Czech Republic

Laufen CZ s.r.o.  
V Tuřích 3/1637  
CZ-120 00 Praha 2 – Czech Republic  
Telephone +420 296 337 716  
Fax +420 296 337 713  
[www.roca.cz](http://www.roca.cz)

#### Showroom Praha

I.P. Pavlova 5  
CZ-120 00 Praha 2 – Czech Republic  
Telephone +420 296 337 701

#### Romania

Roca Obiecte Sanitare S.R.L.  
Boulevard Precizie, 1 nr. 1 Sector 6  
062202 – Bucarest – Romania  
Telephone +4031 822 2310  
Fax +4021 318 1418  
[www.roca.com](http://www.roca.com)

#### Russia

Roca Santechnika  
Promyshlennaya Str. 7, Tosno,  
Leningrad region, 187000 – Russia  
Telephone +7 812 347 94 49  
Fax +7 812 347 94 50  
[www.roca-russia.ru](http://www.roca-russia.ru)

#### Roca Santechnika (Moscow)

Altufievskoye shosse, 1/7  
Moscow, 127106 – Russia  
Telephone +7 495 956 33 30 / 230  
65 48  
Fax +7 495 234 07 97  
[www.roca-russia.ru](http://www.roca-russia.ru)

#### Ukraine

Laufen CZ s.r.o. – Ukraine Office  
19, Ak. Tupoleva str., office "Laufen"  
Kiev 04128 – Ukraine  
Telephone +380 44 499 0620  
Fax +380 44 499 0621  
[www.roca.net.ua](http://www.roca.net.ua)

### Roca in Asia

#### China

Roca (China) Co., Ltd.  
Room 503-505 City Gateway  
No.396 Cao Xi Road North  
200030 Shanghai – China  
Telephone +86 21 33688822  
Fax +86 21 33688299  
[www.roca.cn](http://www.roca.cn)

#### Showroom Shanghai

1F City Gateway  
No.396 Cao Xi Road North  
200030 Shanghai – China  
Telephone +86 21 33688300  
Fax +86 21 33688301

#### Showroom Beijing

Roca Showroom  
1st Floor of Tianheng Plaza  
No.46 of Dongzhimenwai Street  
Dongcheng district  
100027 Beijing – China  
Telephone +86 10 84608586 /  
+86 10 84608588  
Fax +86 10 64176997

#### Hong Kong

Roca Asia Limited  
Room 2303, 23/F  
148 Electric Road, North Point –  
Hong Kong  
Telephone +852 25 06 24 38  
Fax +852 25 06 24 92  
[www.roca.hk](http://www.roca.hk)

#### India

Parryware Roca Pvt. Ltd.  
Dare House, 234, N.S.C. Bose Road  
Chennai 600 001 – India  
Telephone +91 44 2530 6789  
Fax +91 44 2534 0034  
[www.rocaindia.com](http://www.rocaindia.com)

#### Malaysia

Johnson Suisse Sdn. Bhd. (257640-V)  
Lot 2, Jalan 225, Petaling Jaya,  
46100 Selangor Darul Ehsan – Malaysia  
Telephone +603 7952 2522  
Fax +603 7958 6860  
[www.roca.com](http://www.roca.com)

#### Middle East

Roca Sanitario, S.A.  
(Representation Office)  
Sheikh Zayed Road, 4th Interchange  
Gold & Diamond Park, Building 5, Office  
111 P.O. Box 282337, Al Quoz Branch  
Dubai – United Arab Emirates  
Telephone +971 4 347 64 00  
Fax +971 4 347 64 08  
[www.roca.com](http://www.roca.com)

#### Singapore

Johnson Suisse (Singapore) Pte Ltd  
No. 2, Clementi Loop, #04-01  
Logishub @ Clementi  
Singapore 129809  
Tel +65 6261 6133  
Fax +65 6265 5979  
[www.roca.com](http://www.roca.com)

### Roca in Africa

#### Morocco

Roca Maroc, S.A.  
Route de Marrakech, Km. 2,5  
B.P. 571 – 26000 Settât – Morocco  
Telephone +212 23 40 5941 / 40 3939  
Fax +212 23 40 5942  
[www.roca.com](http://www.roca.com)

#### Showroom Casablanca

96, Bd Massira Al Khadra  
20100 Casablanca – Morocco  
Telephone +212 22 39 6096  
Fax +212 22 36 6019

### Roca in America

#### Argentina

Roca Argentina, S.A.  
Camino Gral. Belgrano,  
2873 – B1824JRH  
Lanús – Buenos Aires – Rep. Argentina  
Telephone +54 11 4365 5000  
Fax +54 11 4365 5024  
[www.roca-argentina.com.ar](http://www.roca-argentina.com.ar)

#### Brazil

Roca Brasil Ltda.  
Av. 14 de Dezembro, 2800  
Vila Mafalda 13206 – 105  
Jundiaí – SP – Brazil  
Telephone +51 11 3378 4827  
Fax +51 11 3378 4629  
[www.rocabrasil.com.br](http://www.rocabrasil.com.br)

#### Showroom São Paulo

Avenida Brasil, 2188  
Jardim América  
São Paulo – SP – CEP 01430-001  
– Brazil  
Telephone +51 11 3061 5266

### Roca in Oceania

#### Australia

Roca  
Macquarie House  
Level 13, Office 1318  
167 Macquarie Street  
Sydney NSW 2000 – Australia  
Telephone +61 (0) 2 86673069  
[www.roca.com](http://www.roca.com)





THE LEADING GLOBAL  
BATHROOM BRAND  
[www.roca.com](http://www.roca.com)