

Front View

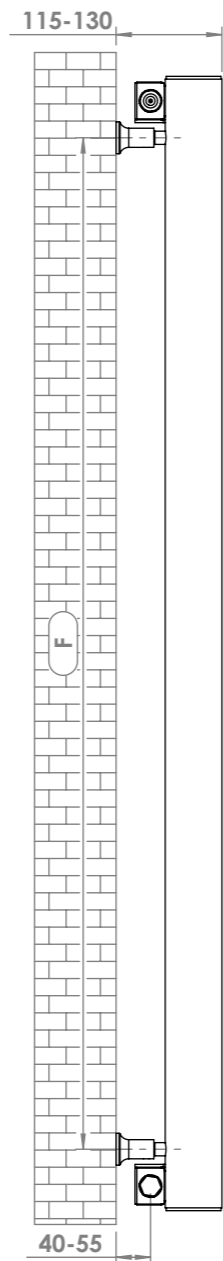

Side View

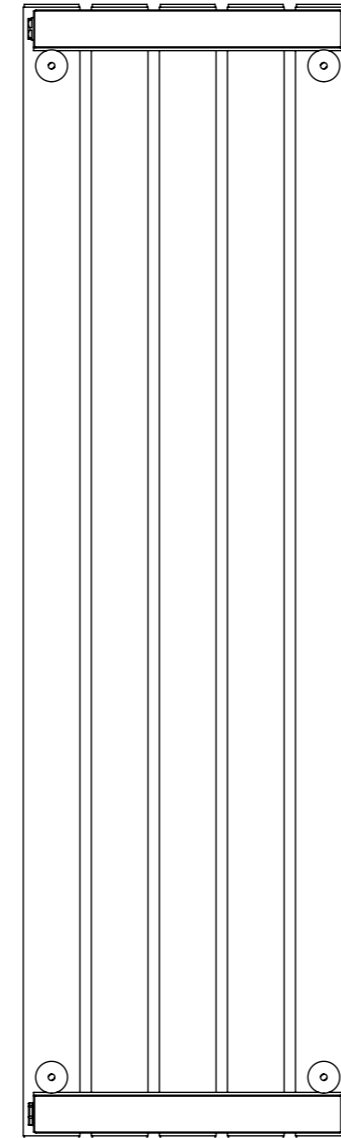

Back View

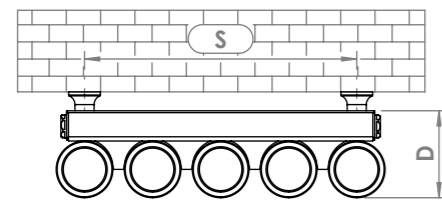
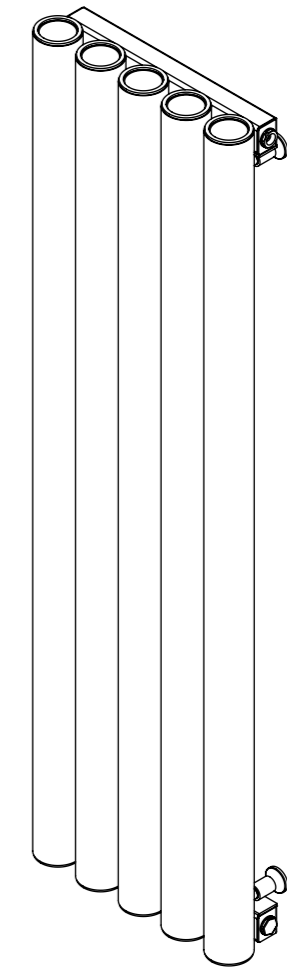

Top View

**Installation Accessories:**

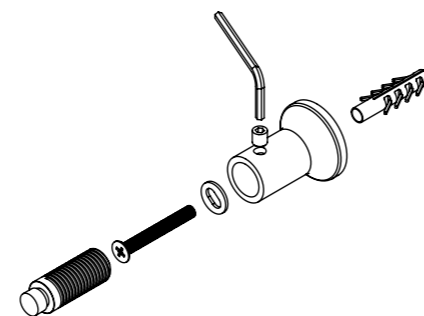
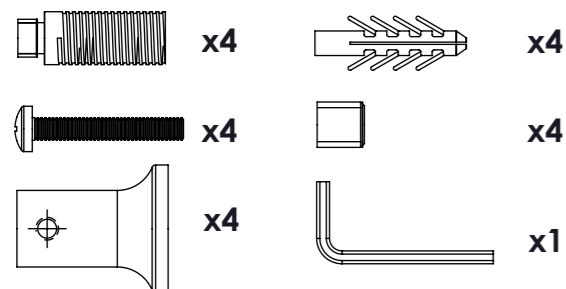

**Plumbing Position:**

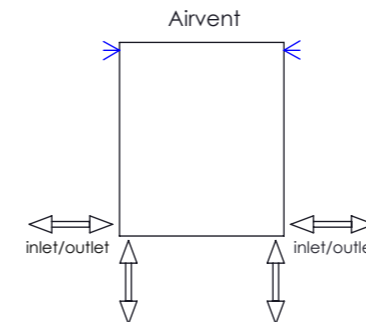

Vertical/horizontal mount  
 All Dimensions are in mm  
 Max.Working Pressure: 10 Bar  
 Max.Working Temperature: 120° C  
 Inlet / Outlet : 1/2" BSP  
 Fuel : E/H/D

Manufacturing Tolerance : - 5 mm

Height	Length	Depth	Pipe Centres	Bracket Centres	Heat Output		
H	L	D	C	F	S	BTU	Watts
mm	mm	mm	mm	mm	mm		
400	340	90	280	270	280	1127	330
400	410	90	350	270	350	1353	396
400	480	90	420	270	420	1578	462
400	550	90	490	270	490	1803	528
400	620	90	560	270	560	2029	594
400	690	90	630	270	630	2254	660
400	830	90	770	270	770	2705	792
400	970	90	910	270	910	3156	924
400	1110	90	1050	270	1050	3607	1056
600	340	90	280	470	280	1691	495
600	410	90	350	470	350	2029	594
600	480	90	420	470	420	2367	693
600	550	90	490	470	490	2705	792
600	620	90	560	470	560	3043	891
600	690	90	630	470	630	3381	990
600	830	90	770	470	770	4058	1188
600	970	90	910	470	910	4734	1386
600	1110	90	1050	470	1050	5410	1584
1500	270	90	210	1370	210	3429	1004
1500	340	90	280	1370	280	4287	1255
1500	410	90	350	1370	350	5144	1506
1500	550	90	490	1370	490	6859	2008
1800	270	90	210	1670	210	4085	1196
1800	340	90	280	1670	280	5106	1495
2000	270	90	210	1870	210	4550	1332
2000	340	90	280	1870	280	5687	1665
2000	410	90	350	1870	350	6824	1998
2000	480	90	420	1870	420	7962	2331
2000	550	90	490	1870	490	9099	2664